

## HILTON BUDAPEST THE FACTS



Blending centuries of heritage with modern design, Hilton Budapest offers an unforgettable experience. Nestled between impressive neo-Romanesque and Gothic architecture, this contemporary hotel lies in the heart of the historic Royal Castle District, now a UNESCO World Heritage Site. Just 15 minutes from the city centre, 40 minutes from the airport and surrounded by major attractions, it is an ideal base for business or leisure with world-class facilities and friendly service.

### AT A GLANCE

- Recently renovated hotel
- 322 spacious guest rooms
- Free Wi-Fi throughout the hotel
- Executive Lounge
- Magnificent views across the Danube and old city
- Conference and event space for up to 600 delegates
- 23 flexible meeting and breakout rooms
- Open-air venues within the hotel

## OUR ROOMS

### SUPERIOR ROOMS

Unwind in this modern 31 m<sup>2</sup> guest room featuring a media hub, a 42-inch HDTV and bedside USB ports. Refresh in the walk-in shower or bathtub in the bathroom with a granite-topped vanity and mirror lighting.



### EXECUTIVE ROOMS

Work is easy in this spacious room with an upgraded, marble bathroom. Enjoy Executive Lounge access with complimentary breakfast, an evening service and daily refreshments.

### SUITES

Spoil yourself in an elegant suite which offers separate areas for sleeping, relaxing and dining. Some suites offer striking views overlooking the river.



### DANUBE VIEW ROOMS

Enjoy all the benefits of our guest rooms with the addition of spectacular views across the Danube, Parliament building and the old city.

## OUR FACILITIES

### FITNESS CENTER

Featuring the latest generation of cardio and strength training equipment, the 24 hour Fitness Center, located on the first floor, takes a personalised approach to help you feel your best during your stay. Unwind with a soothing sauna or professional massage in the comfort of our treatment rooms.

### EXECUTIVE LOUNGE

The hotel's top-rated Executive Lounge awaits you every day from 6 AM to 10 PM offering breakfast, snacks and refreshments throughout the day and hot canapés in the evenings.

### BUSINESS CENTER

Designed for productivity and comfort, facilities and services include PCs with Internet access, printing, photocopying and faxing, rental of technical equipment and professional secretarial services.

## EAT & DRINK

### ICON RESTAURANT

Enjoy Hungarian and International specialities in this stylish restaurant overlooking the Danube, Fisherman's Bastion and Parliament building.



### LOBBY CAFÉ & BAR

Treat yourself to a speciality coffee, classic cocktail or draught beer in this impressive bar overlooking the Dominican Courtyard and the iconic Parliament building. Innovative light meals are also in the menu together with our popular Hilton Classics and a wide selection of fine Hungarian wines.

## OUT & ABOUT

Hilton Budapest is surrounded by historical sights and numerous attractions including:

- Fisherman's Bastion
- Matthias Church
- The former Royal Palace
- 16th century baths with art deco detailing



## LOCATION

The hotel is conveniently situated in the historic Castle District, just 10 minutes from Budapest Congress Centre by car. The city's main attractions are also just minutes away which can be easily reached by bus NR16 which stops nearby. Budapest Airport is only 40 minutes away by car.

Hilton Budapest

Hess András tér 1-3 | Budapest | 1014 Hungary

T: +36 (0)1 889 6600

F: +36 (0)1 889 6644

E: [info.Budapest@hilton.com](mailto:info.Budapest@hilton.com)

[budapest.hilton.com](http://budapest.hilton.com)

## MEETINGS

Host special events, business meetings or dream weddings for up to 600 guests in one of 24 versatile meeting rooms, or celebrate in a stunning outdoor venue with spectacular Budapest views.



### DOMINICAN COURTYARD & CLOISTER

Through superb architectural planning, the preserved remains of a 13th century Dominican cloister and monastery have been incorporated into the contemporary structure of the hotel. The churchyard and the cloister are unique open-air venues for banquets, receptions, coffee breaks, summer lunches and wedding ceremonies for up to 300 guests.



### CONFERENCE & BALLROOM

The completely redesigned Conference & Ballroom is the perfect venue for gala dinners, conferences and exhibitions for up to 600 guests.



### HISTORICAL LOUNGE

A new entrance and access point welcomes groups arriving by coaches. Upon entering the building, guests walk through under a 300.000 year old limestone quilt. From there the new panoramic elevators take them up to the Historical Lounge where they can check-in and check-out at the dedicated Reception desk.



## HERE ON BUSINESS

Our fully-equipped Business Centre offers all the facilities you may need, supported by our dedicated Business team. Stay productive with modern PC workstations, high speed internet access, printing, photocopying, faxing and professional secretarial services.

## MEETINGS & EVENTS

Discover the city's most versatile convention facility with 24 flexible rooms and a 333m<sup>2</sup> exhibition space, fully-equipped with advanced conference technology and high speed wireless internet. Our professional team are on hand to assist 24 hours, 7 days a week.

MEETING ROOM	Boardroom	U-Shape	Theatre	Classroom	Cabaret	Banquet	Reception	Floor	Dimensions L x W x H (m)	Sq meter	Natural Daylight
Anjou	42	36	110	60	42	70	80	Historical	14.2x6.8x2.8	97	•
Visegrád	12	—	20	—	—	—	—	Historical	4.2x6.4x2.7	27	
Matthias Rex	42	36	85	60	42	70	80	Historical	13.0x6.3x2.4	81	
Beatrix	24	18	40	24	14	30	30	Historical	6.9x7.0x2.4	48	
Gizella	18	15	40	18	21	40	30	Lobby	8.0 x 8.0 x 3.0	59	•
Corvina 1	22	20	60	40	35	50	40	Lobby	8.9x7.1x2.7	63	•
Corvina 2	22	20	45	28	28	40	30	Lobby	8.4x6.2x2.7	52	•
Corvina 3	22	20	50	28	28	40	30	Lobby	9.0x6.4x2.7	58	
Corvina 4	22	22	50	28	21	30	30	Lobby	10.4x5.8x2.7	60	•
Corvina 1 + 2 + 3 + 4	—	—	—	—	—	250	210	Lobby	17.9x20.6x2.7	333	•
Corvina 1 + 2	50	44	130	80	56	90	80	Lobby	17.4x6.2x2.7	108	•
Corvina 3 + 4	50	50	132	66	56	80	70	Lobby	19.8x6.3x2.7	126	•
Conference & Ballroom A	63	57	210	99	84	120	150	Ballroom	8.1x20.4x4.4	165	
Conference & Ballroom B	63	57	200	132	84	120	160	Ballroom	8.4x20.4x4.4	171	
Conference & Ballroom C	63	57	200	132	84	120	160	Ballroom	8.4x20.4x4.4	171	
Conference & Ballroom A + B	90	72	400	231	168	240	350	Ballroom	16.5x20.4x4.4	337	
Conference & Ballroom B + C	90	72	400	231	168	240	350	Ballroom	16.8x20.4x4.4	343	
Conference & Ballroom A + B + C	114	87	600	363	252	360	500	Ballroom	25.0x20.4x4.4	510	
Endre	18	15	30	18	—	20	20	Ballroom	7.2x4.8x2.7	35	•
Béla	18	15	30	18	—	20	20	Ballroom	7.2x4.8x2.7	35	•
Levente	18	15	30	18	—	20	20	Ballroom	7.2x4.8x2.7	35	•
Endre + Béla	36	33	66	36	28	50	40	Ballroom	14.4x4.8x2.7	69	•
Béla + Levente	36	33	66	36	28	50	40	Ballroom	14.4x4.8x2.7	69	•
Endre + Béla + Levente	60	57	105	64	42	80	70	Ballroom	21.6x4.8x2.7	104	•
Boardroom 1	15	—	—	—	—	—	—	5 <sup>th</sup> Floor	5.5x7.1x2.4	39	•
Boardroom 2	10	—	—	—	—	—	—	2 <sup>nd</sup> Floor	5.2x3.5x2.3	18	•
Boardroom 4	10	—	—	—	—	—	—	4 <sup>th</sup> Floor	5.2x3.5x2.3	18	•
Boardroom 5	10	—	—	—	—	—	—	5 <sup>th</sup> Floor	5.2x3.5x2.3	18	•
Margit	54	51	120	66	56	100	80	6 <sup>th</sup> Floor	18.4 x 5.4 x 3.5	145	•
Parlament	36	30	75	54	42	60	50	6 <sup>th</sup> Floor	11.2x9.0x3.5	106	•
Erzsébet	36	33	60	33	28	40	30	6 <sup>th</sup> Floor	12.2x5.0x3.5	61	
Tower	24	18	20	27	28	40	20	6 <sup>th</sup> Floor	7.0x7.0x3.5	49	
<b>OTHER</b>											
Historical Hall	—	—	—	—	—	—	—	Historical	15.0x7.2x2.9	108	•
Ballroom Foyer	—	—	—	—	—	—	150	Ballroom	35.5x6.5x2.4	252	•
Entrance Foyer	—	—	—	—	—	—	80	Lobby	15.0x6.0x2.9	90	•
Dominican Courtyard	—	—	—	—	—	200	400	Open Air	61.0 x 11.0	671	•
Dominican Cloister Yard	—	—	—	—	—	60	80	Open Air	16.0x12.0	192	•
Historical Promenade	—	—	—	—	—	—	80	Open Air	—	—	•

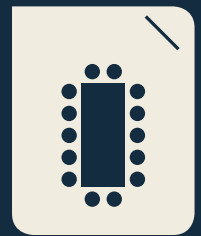

Boardroom

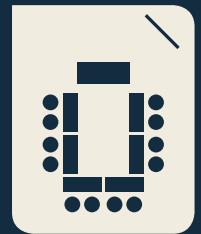

U-shaped

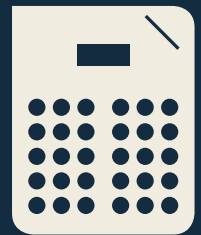

Theatre



Classroom

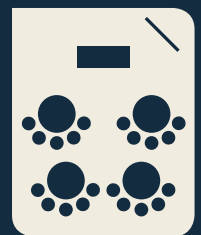

Cabaret

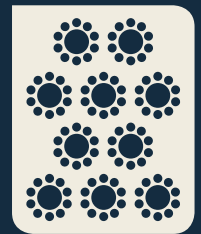

Banquet

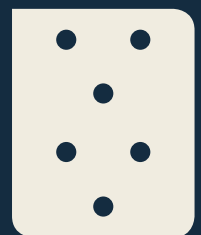

Reception



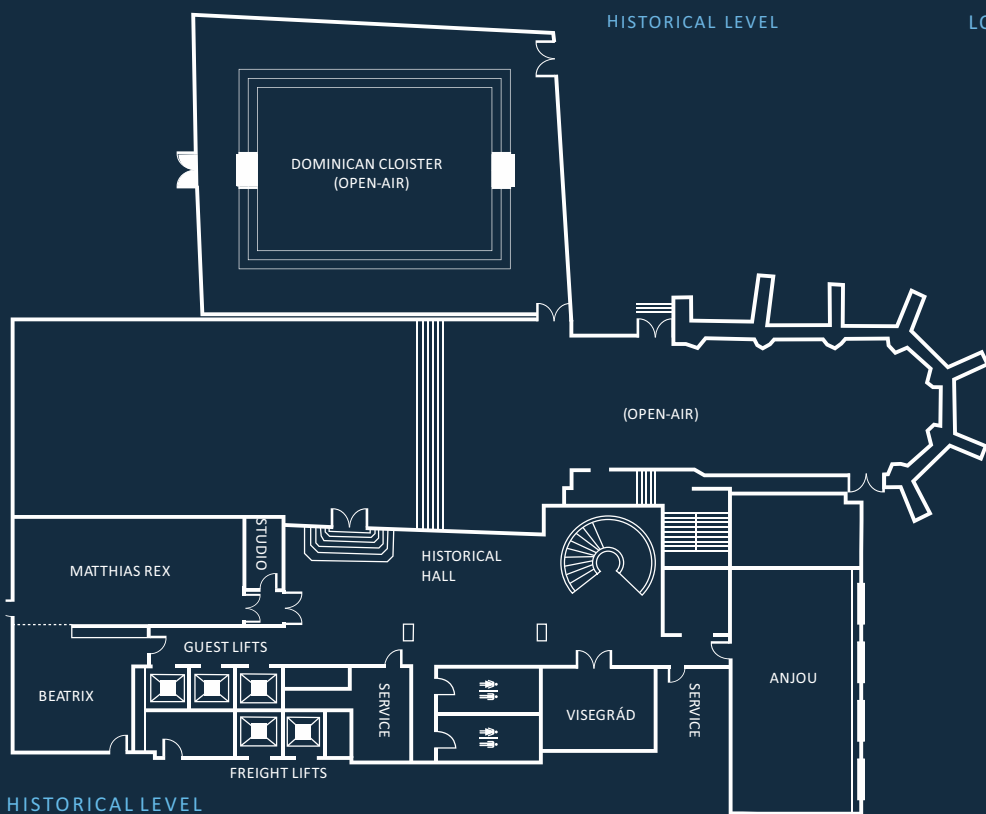

HISTORICAL LEVEL

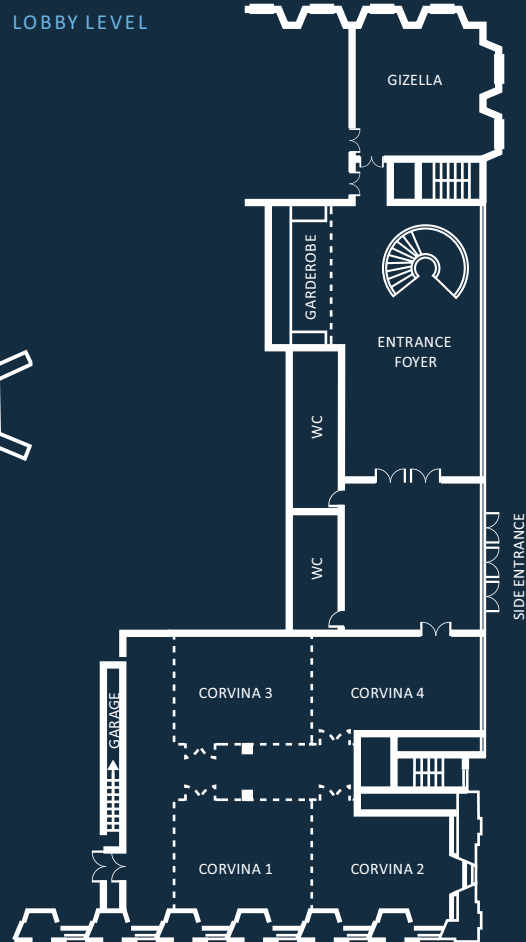

BALLROOM LEVEL

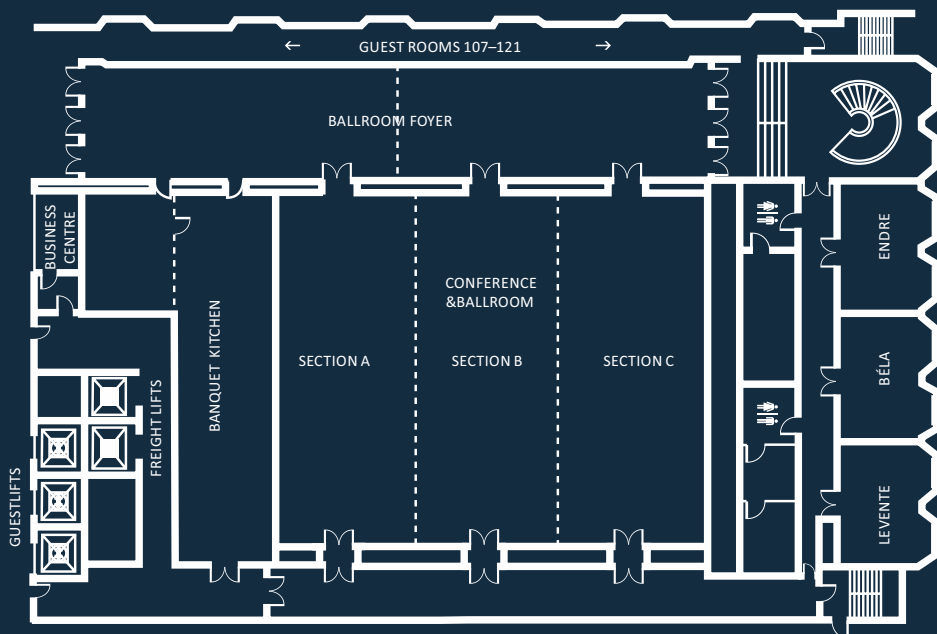

5<sup>th</sup> FLOOR

6<sup>th</sup> FLOOR

